

Handlebar Remote Quick Start Guide

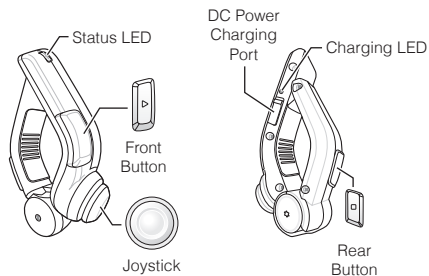

Installation

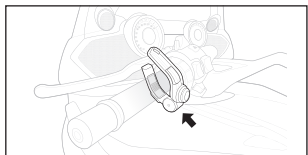

Charging

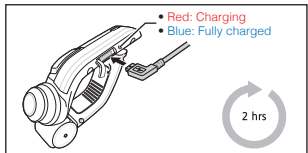

Button Operation

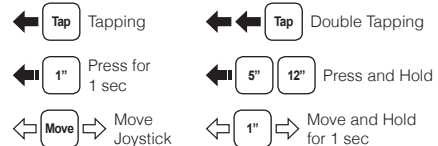

Handlebar Remote Power On/Off

Power On

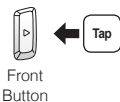

Power Off

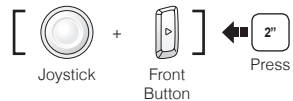

Handlebar Remote Battery Check

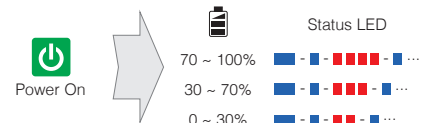

Handlebar Remote - Bluetooth Headset Pairing

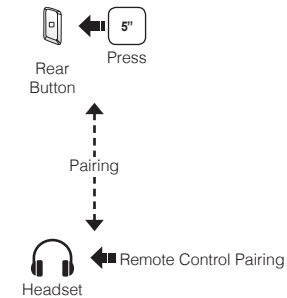

Note:

- You can control the headset using the Handlebar Remote only after you pair them together.
- The Handlebar Remote supports Sena headsets with Bluetooth 4.0.

Handlebar Remote Factory Reset

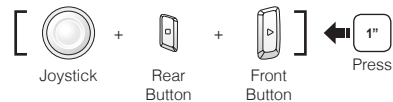

Handlebar Remote Button Matching

Once the Handlebar Remote and the Headset are paired, the buttons match in the following order.

Jog Dial Type Headsets

Handlebar Remote	Jog Dial Type Headset
Joystick ← 1" Press	Jog Dial ← Tap
Joystick ↑ Move ↓	Jog Dial Rotating
Joystick ← 1" → Move	Jog Dial Rotating while Pressing
Front Button ← Tap	Phone Button ← Tap

Other Type Headsets

Please go through the button instructions in the following pages.

Note:

The Rear Button controls distinct headset buttons such as the Ambient Mode Button of the 20S.

Headset Volume Adjustment



Headset Configuration Menu



Phone, Music Pairing

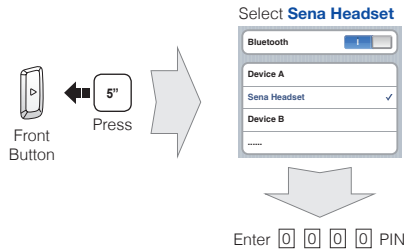

Music Operation

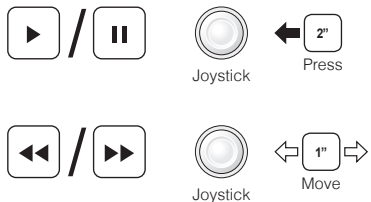

Mobile Phone Call Making and Answering

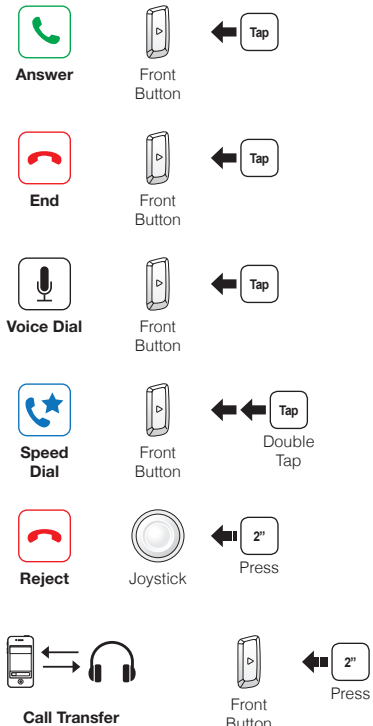

Intercom Pairing

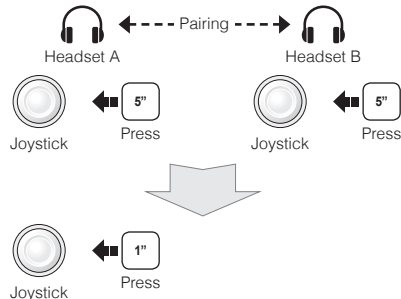

Intercom Start/End

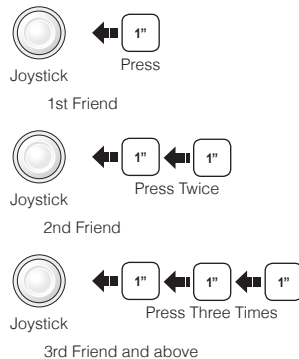

Radio On/Off

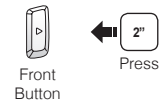

Radio Seek Stations



Radio Scan Up FM Band

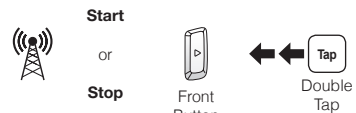

Save to preset while scanning



Radio Move to Preset Station



Radio Save or Delete Preset

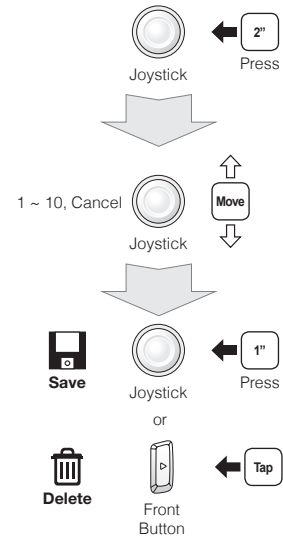

Follow us on our Facebook page.
www.facebook.com/senablueetooth

Sena Technologies, Inc.

www.sena.com
Customer Support: support.sena.com
Tel: 408-300-9797
E-mail: support@sena.com

SENA